

TRL2009071123

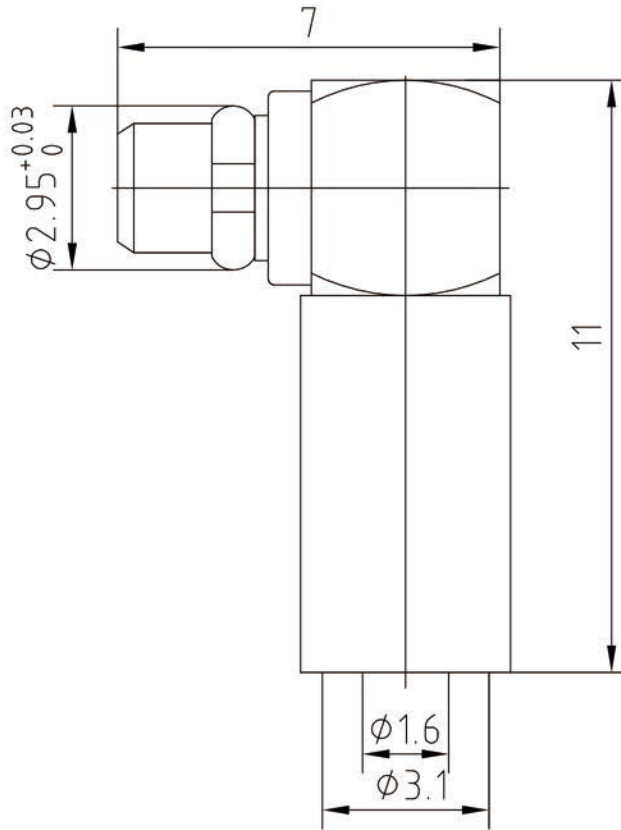

1 Electrical Data:

- 1.1 Impedance: 50Ω
- 1.2 Frequency: 0-6GHz
- 1.3 VSWR ≤1.25
- 1.4 Insulation resistance: ≥1000MΩ
- 1.5 Dielectric withstanding voltage: 500V
- 1.6 Center Contact resistance ≤ 10MΩ
- 1.7 Outer Contact resistance ≤ 5MΩ

2 Material&Finish

- 2.1 Inner Contact: Phosphor Bronze, gold plated
- 2.2 Outer Contact: brass, gold plated
- 2.3 Insulators: PTFE
- 2.4 Spring contact, beryllium copper, gold plated

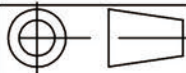

Scale

1:1

Name

Date

Designed Tomson Tang 11-Jul-09

Checked Jason Cai 11-Jul-09

Approved Magi Wang 11-Jul-09

MMCX-JW3

MMCX male right angle connector  
for RG316 cable

UNLESS OTHERWISE SPECIFIED  
DIMENSIONS ARE mm, TOLERANCES ARE:  
FRACTIONS DECIMALS ANGLES  
.X± .15 ±1°  
.XX± .05  
.XXX±



www.rf-connector-china.com